

1st Floor

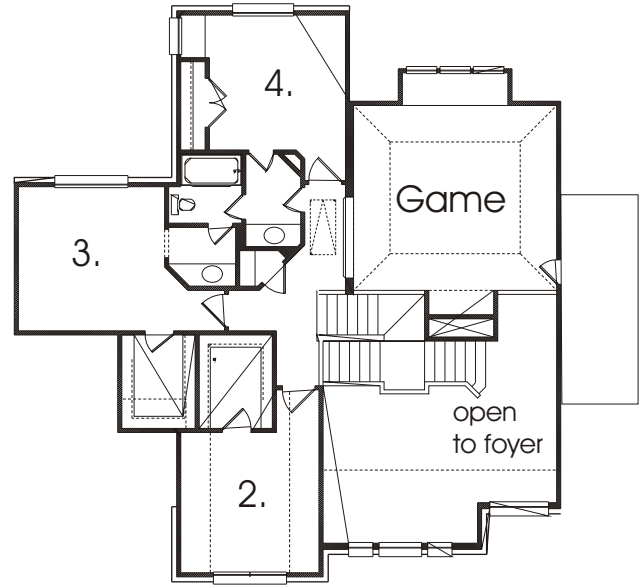

2nd Floor

The Addison

This home features a grand foyer with high ceilings that show off the split stairway. The stair comes down back by the Utility Room and the Living Room. The extra large Garage opens to the front and the back.

Specifications

1st floor 2,084
2nd floor 1,147

Total Living Area 3,231 Sq. Ft.

4 Bedrooms, 3 1/2 Baths, 3 Living Areas, Study
71'-11" Wide x 51'-2" Deep

1st Floor

Living Room 12'-8" x 13'-0"
Family Room 16'-8" x 15'-2"
Dining Room 11'-4" x 13'-0"
Master Bedroom 15'-11" x 14'-9"
Kitchen 13'-6" x 10'-2"
Breakfast 13'-6" x 11'-0"
Study 13'-0" x 11'-0"

2nd Floor

Bedroom #2 11'-4" x 11'-6"
Bedroom #3 12'-0" x 12'-0"
Bedroom #4 11'-2" x 11'-1"
Game 16'-8" x 15'-2"



Floor plans & elevations are subject to change and dimensions are approximate. Purchasers are advised consult their state and local building authorities and a state certified architect prior to any construction related to these plans.
© Copyright 1998